

Parts Catalog

***ICC - Tub 3300, 3600, 3600XL, 3700, 3750, 3800,
4300, 5300***



www.mpsource.com
941-342-7725



Yes, you can.

TABLE of CONTENTS

Description	Page Number
01. ICC Tubs	4
02. Access Doors and Panels	5
03. Disinfectant System Components	7
04. Door Assemblies	9
05. Door Frame Assembly	11
06. Door Handle and Safety Latch Components	12
07. Door Hinge Assembly	14
08. Door Probe Locking Assemblies	16
09. Faceplate Components	18
10. Faceplates	20
11. Safety Harness and Grab Bar	21
12. Inner Tub Shell Components	22
14. Whirlpool Inlet Assembly	24
15. Jet Assembly	26
16. Overflow Assembly	27
17. Mixing Valves - RADA 17	28
18. Mixing Valves - RADA 20	30
19. Mixing Valves - RADA 222	31
20. Outer Tub Shell and Components	33
21. Pump	35
22. Plastic Tube and Fittings	37

TABLE of CONTENTS

Description	Page Number
23. PVC Fittings and Pipe	39
24. Tub and Shower Valves - For Lynwood and Gerber	41
25. Tub and Shower Valves - For Dornbracht "Aida", Gummers, and Symmons	43
26. Accessories - Optional	45



ICC Tubs



Access Doors, Panels, and Components

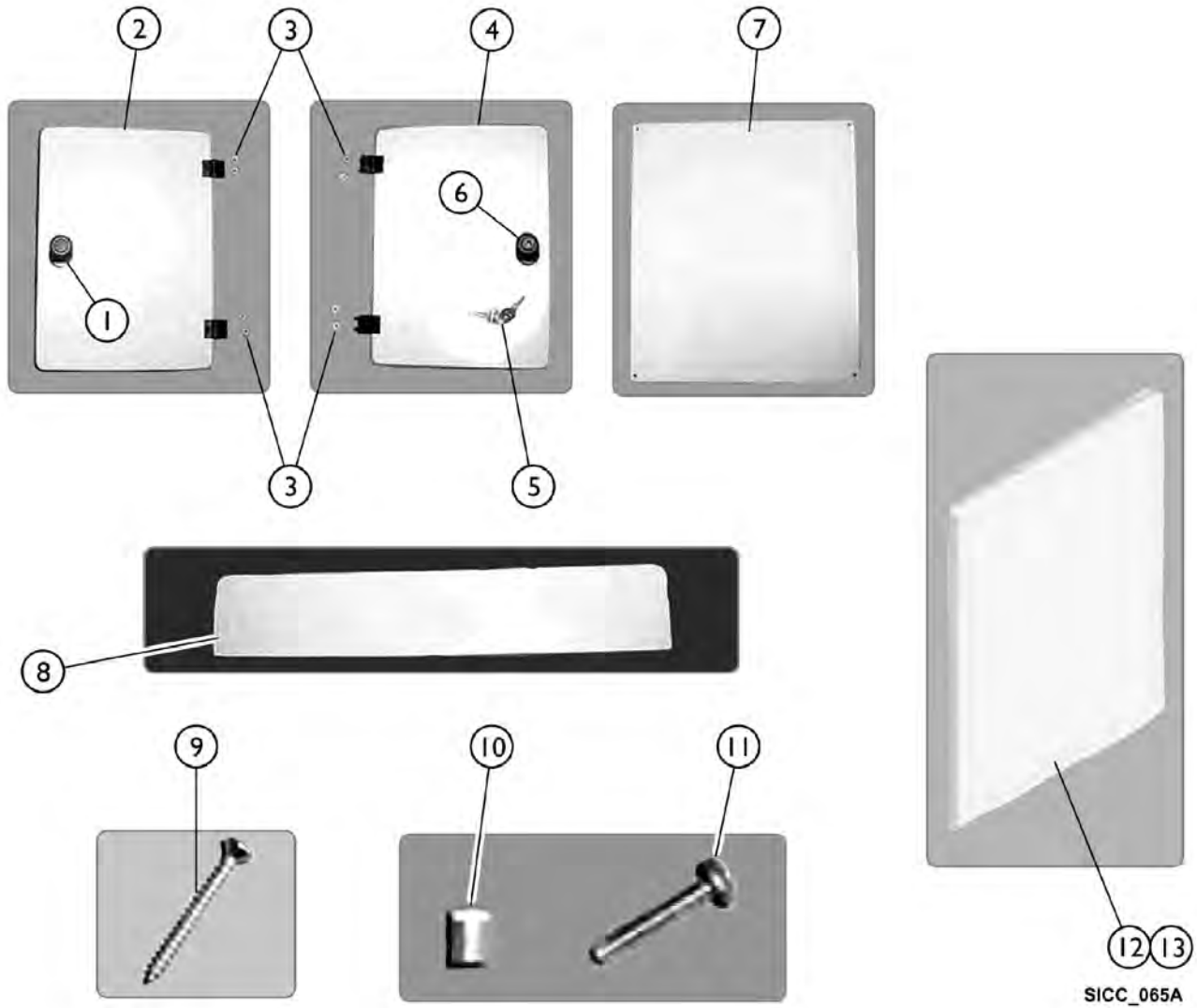

SICC_065A



Access Doors, Panels, and Components

Item Number	Note	Part Number	Description	Quantity Per	
				Package	Assembly
1	B	IHPAR7901A-NL A	NLA - Disinfectant Locking Door Latch Assembly (Includes keys)	1	1
2	B	PARP35A-NLA	NLA - Door, Almond Side Access	1	1
2	B	PARP35W-NLA	NLA - Door, White Side Access	1	1
3	A	PAR5410	Hinge, Access Door	1	1
4	A	PARP36A-NLA	NLA - Disinfectant Access Door, Almond	1	1
4	A	PARP36W-NLA	NLA - Disinfectant Access Door, White	1	1
5	A	IHPAR7903-NLA	NLA - Key Set	1	1
6	A	IHPAR7901A-NL A	NLA - Disinfectant Locking Door Latch Assembly (Includes keys)	1	1
7	B	PARP33A-NLA	NLA - Panel, Almond Back Access	1	1
7	B	PARP33W	Panel, White Back Access	1	1
8	C	PARP32A-NLA	NLA - Panel, Almond Bottom Front Access	1	1
8	C	PARP32W	Panel, White Bottom Front Access	1	1
9	C	IHPAR9909-NLA	NLA - Screw, Phillips, Flat Head, Oval (6-32 x 1-1/4")	1	10
10	C	1097286	Threaded Insert (#10-24)	1	4
11	C	PAR9938-NLA	NLA - Screw, Phillips, Pan Head (10-24 x 1")	1	4
12	D	IHPARSPLW	Panel, Access - Left	1	1
13	D	IHPARSPRW	Panel, Access - Right	1	1
	E	IHPAR9243W-N LA	NLA - Gel - Coat Kit, White	1	1
	E	IHPAR9243B	Gel - Coat Kit, Bisque	1	1
	E	IHPAR9243A	NLA - Gel - Coat Kit, Almond	1	1

NOTE: A - For All Models.
B - For Models 3300, 3600, 3600XL, 4300, and 5300
C - For Models 3700 Series, 3750, and 3800 Only.
D - For Models 3750 - 3800 Only.
E - Not included in photos.

Disinfectant System Components

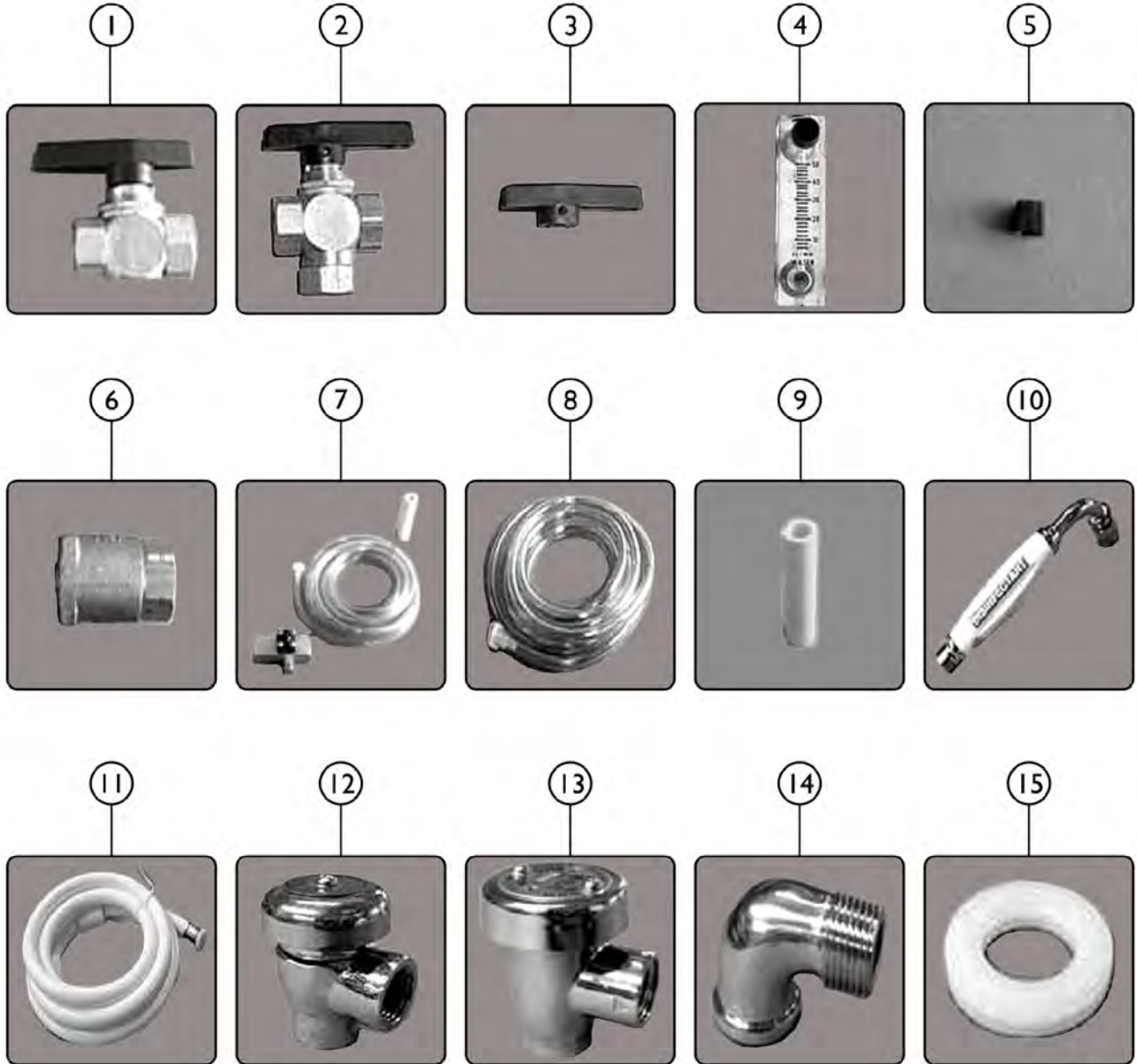

SICC_069A

Disinfectant System Components

For Models 3600, 3600XL, 3700, 3750, 3800, 3300, 4300, 5300

Item Number	Note	Part Number	Description	Quantity Per	
				Package	Assembly
1		PAR1110C	Valve, Two Way Ball (Disinfectant on/off)	1	1
2		IHPAR1111C-NL A	NLA - Valve, Three Way Ball (Diverter valve version)	1	1
3		PAR1110	Handle, Replacement	1	1
4		PAR1108	Metering Valve	1	1
5		IHPAR1106	Metering Valve Replacement Knob	1	1
6		PAR5673	Check Valve (1/4" FPT)	1	1
7	A	PAR1030	Injector Assembly (3/8" FPT)	1	1
7	B	1096922-NLA PAR1161	NLA - Injector Assembly (1/2" FPT) Connector, Male (3/8" Tube x 3/8" MP)	1	1 2
8		IHPAR1034	Check Valve and Suction Tube, Disinfectant	1	1
9		IHPAR1032-NLA	NLA - Weight, Ceramic (for disinfectant suction tube and check valve)	1	1
10	C	PAR5087B-NLA	NLA - Wand, Disinfectant	1	1
11		PAR5118G	Hose, Shower and Disinfectant Wand	1	1
12		PAR7380AG	Back Flow Preventer - Conbraco (1/2") (One Screw in Cap)	1	1
12a		IHPAR7383C	Bonnet	1	1
	D	IHPAR7384C	Kit, Repair	1	1
13		IHPAR7380-AG- W	NLA - Back-Flow Preventer, "WATTS" 1/2" (Two screws in cap)	1	1
13		IHPAR7382CW	NLA - Bonnet	1	1
13		IHPAR7384CW	NLA - Kit, Repair	1	1
14		PAR1136	Elbow, 90 Degrees - Chrome	1	1
15		PAR6160D	Washer, Nylon, Backflow Preventer and Chrome Elbow	1	1

NOTE: A - Used on all tubs prior January 2002. Used on 2 jet tubs only from January 2002 to March 2004. Used on all tubs after March 2004.
B - If 1/2" FRT Thread connections, order (2 ea.) part number PAR1161.
C - Used on all models except 3700 series / 3750 and 3800, discontinued on all models manufactured after March 2004.
D - Not shown in photos.

Door Assemblies

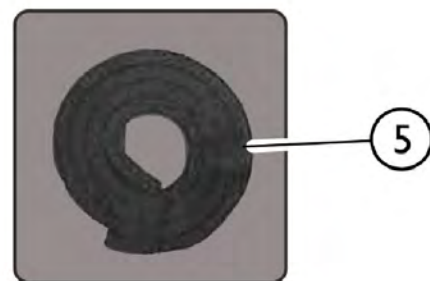
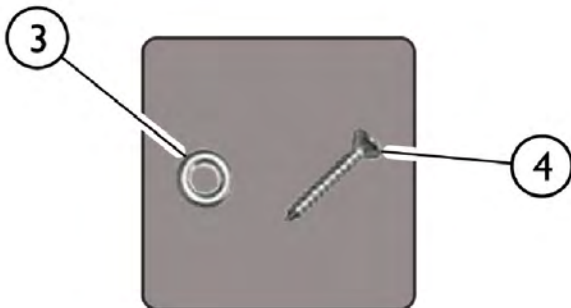
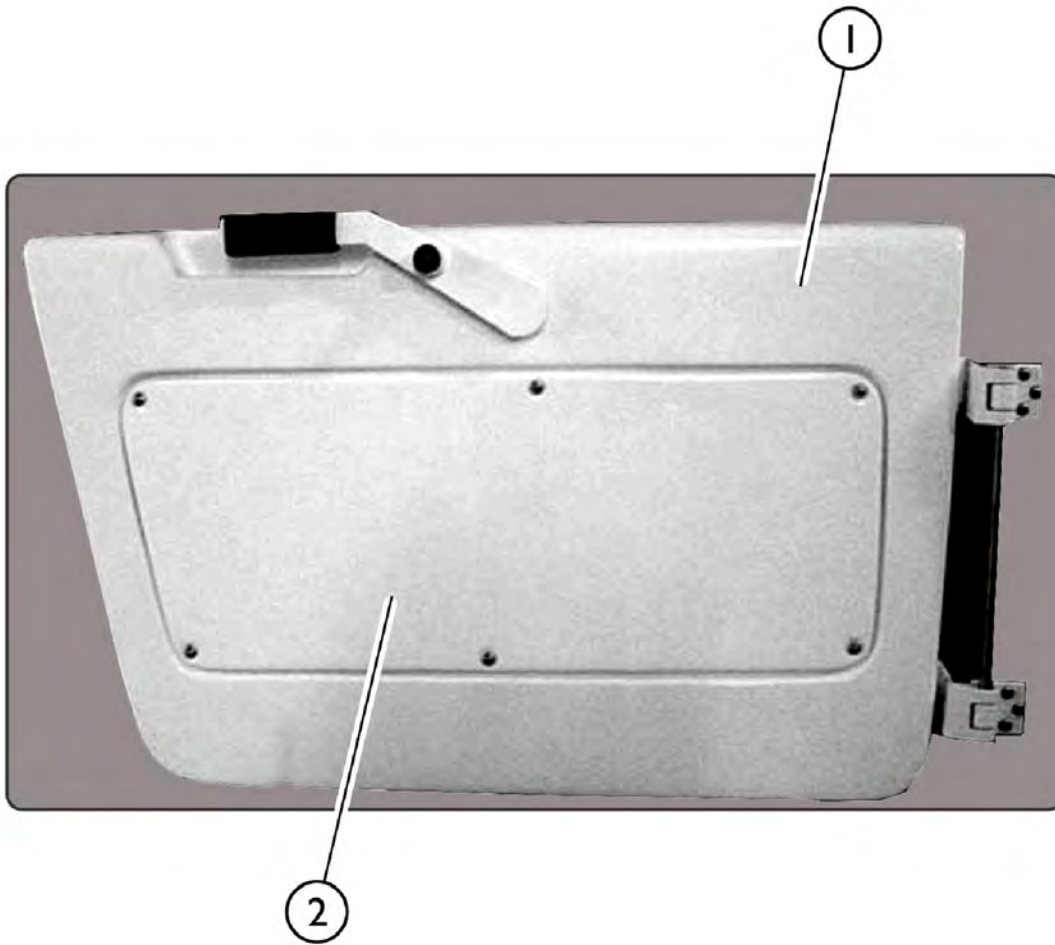

SICC_070A

Door Assemblies

Item Number	Note	Part Number	Description	Quantity Per	
				Package	Assembly
1	A	IHPAR360038D A-NLA	NLA - Door Assembly, Almond	1	1
1		1161008-NLA	NLA - Door Assembly, White	1	1
1		IHPAR9261	Grab Bar (10")	1	1
2		PARP42A-NLA	NLA - Door Panel, Almond	1	1
2		PARP42W	Door Panel, White	1	1
3		IHPAR9907	Washer, #8 Countersunk Finishing	1	1
4		IHPAR9902	Screw, Hex Head (5/16-18 x 2")	1	1
5		1149230	Seal, 6' Door w/ Tape	1	1

NOTE: A - Order Grab Bar for 3750 and 3800 Models.



Door Frame Assembly

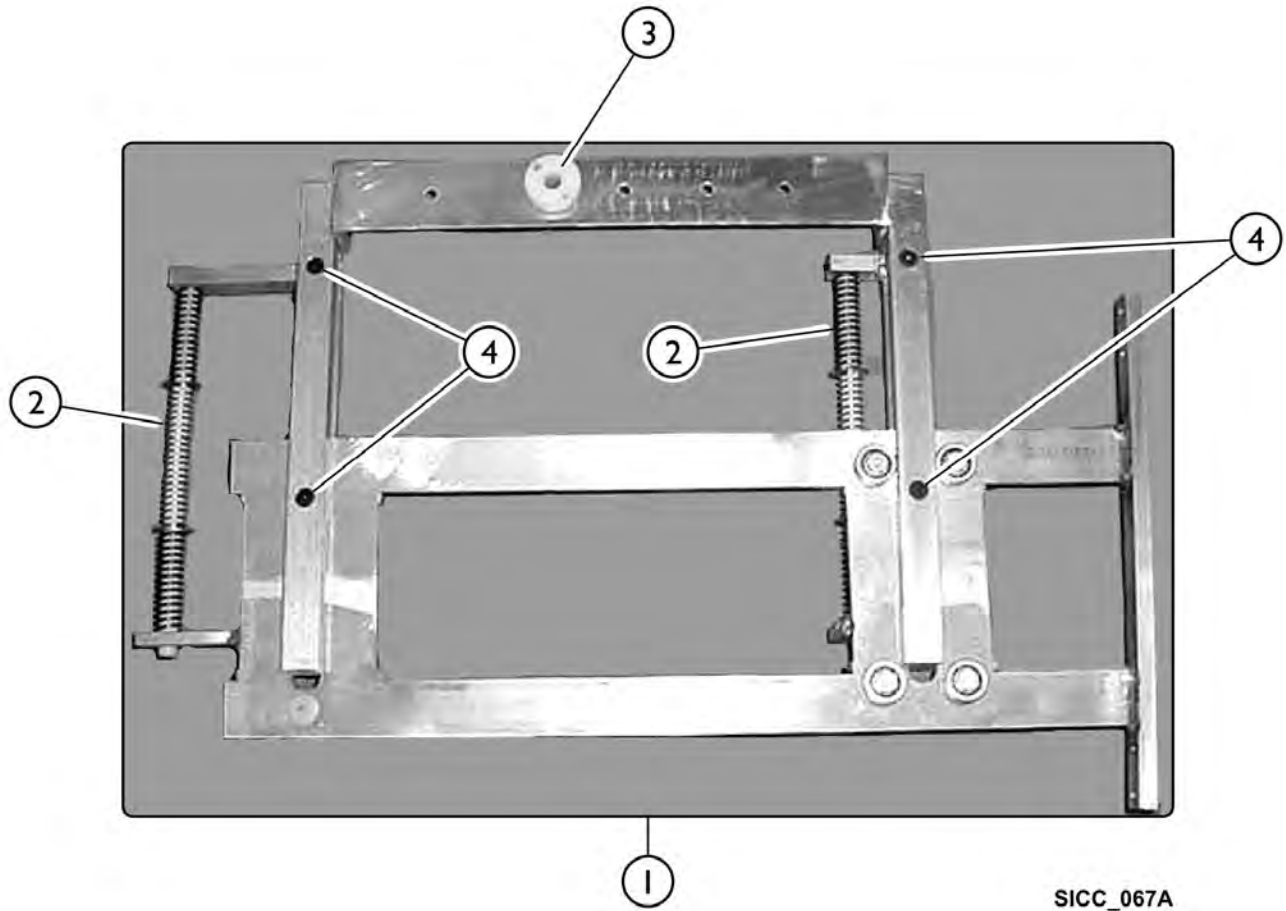

SICC_067A

Item Number	Note	Part Number	Description	Quantity Per	
				Package	Assembly
1	A	PAR3600A	Complete Door Frame Assembly	1	1
2		IHPAR3608L	Spring, Long, Door Hinge	1	1
3		IHPAR3621	Bushing, Door Handle	1	1
4		IHPAR9917	Bolt, Door Hinge Bracket	1	1

NOTE: A - Item includes items 2 - 4.

Door Handle and Safety Latch Components

There is a difference between old style and new style handles (Item #2).

Old Style: Distance between handle pin/hole for the latch pin is 3-3/4"

New Style: Distance between handle pin/hole for the latch pin is 3"

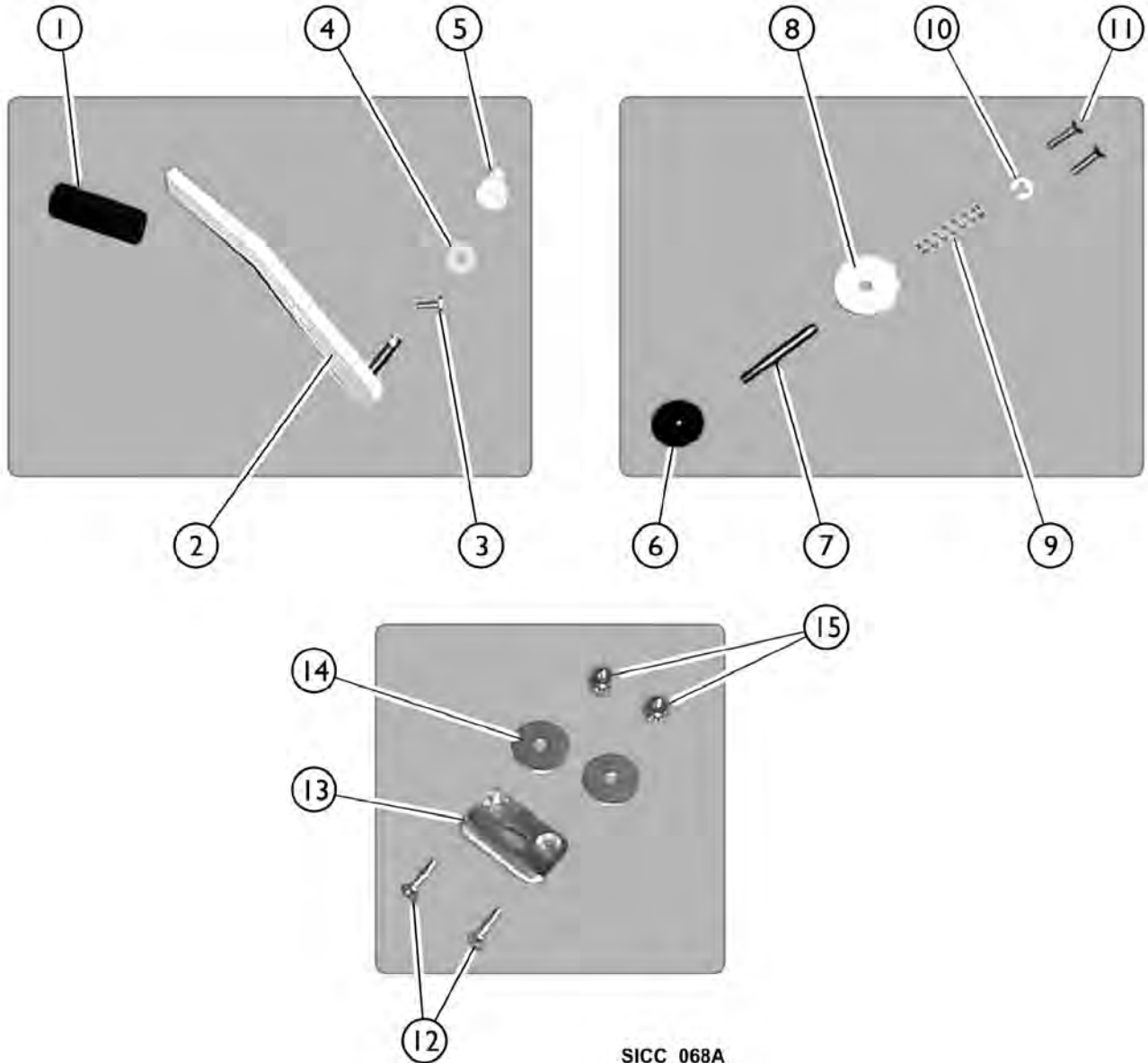

SICC_068A

Door Handle and Safety Latch Components

There is a difference between old style and new style handles (Item #2).

Old Style: Distance between handle pin/hole for the latch pin is 3-3/4"

New Style: Distance between handle pin/hole for the latch pin is 3".

Item Number	Note	Part Number	Description	Quantity Per	
				Package	Assembly
1		TRP1036	Door Handle Grip	1	1
2	A	IHPAR3620A-NL A	NLA - Handle, Door, Almond	1	1
2	A	PAR3620B	Handle, White Door	1	1
2	B	IHPAR3620A-NL A	NLA - Handle, Door, Almond	1	1
2	B	PAR3620B	Handle, White Door	1	1
2	C	IHPAR3702RA- NLA	NLA - Handle, Reverse Door, Almond	1	1
2	C	IHPAR3702RW- NLA	NLA - Handle, Reverse Door, White	1	1
3		PAR9901	Bolt (5/16-18 x 1")	1	1
4		PAR9240A	Washer, Nylon	1	1
5		IHPAR3621	Bushing, Door Handle	1	1
6		PAR3606	Knob, Safety Latch	1	1
7		PAR3601	Pin, Safety Latch	1	1
8		IHPAR3603A-NL A	NLA - Collar, Almond Safety Latch	1	1
8		PAR3603B	Collar, Safety Latch	1	1
9		PAR3604	Spring, Safety Latch	1	1
10		PAR3605	Cir-Clip	1	1
11		IHPAR9911	Screw, Phillips, Flat Head (#10-24 x 3/4")	2	2
12		IHPAR9912	Screw, Phillips, Flat Head (#10-24 x 1")	2	2
13		PAR3607	Striker Plate, Safety Latch	1	1
14		IHPAR9913	Washer, Fender	2	2
15		IHPAR9910	Nut (#10-24)	2	2
NOTE: A - Used on Model 3600, 3600XL, 3750, 3800 Tubs. B - Used on Model 3700A, 3700B, 3700BMF Tubs. C - Used on Model 3700, 3700DMF Tubs.					

Door Hinge Assembly

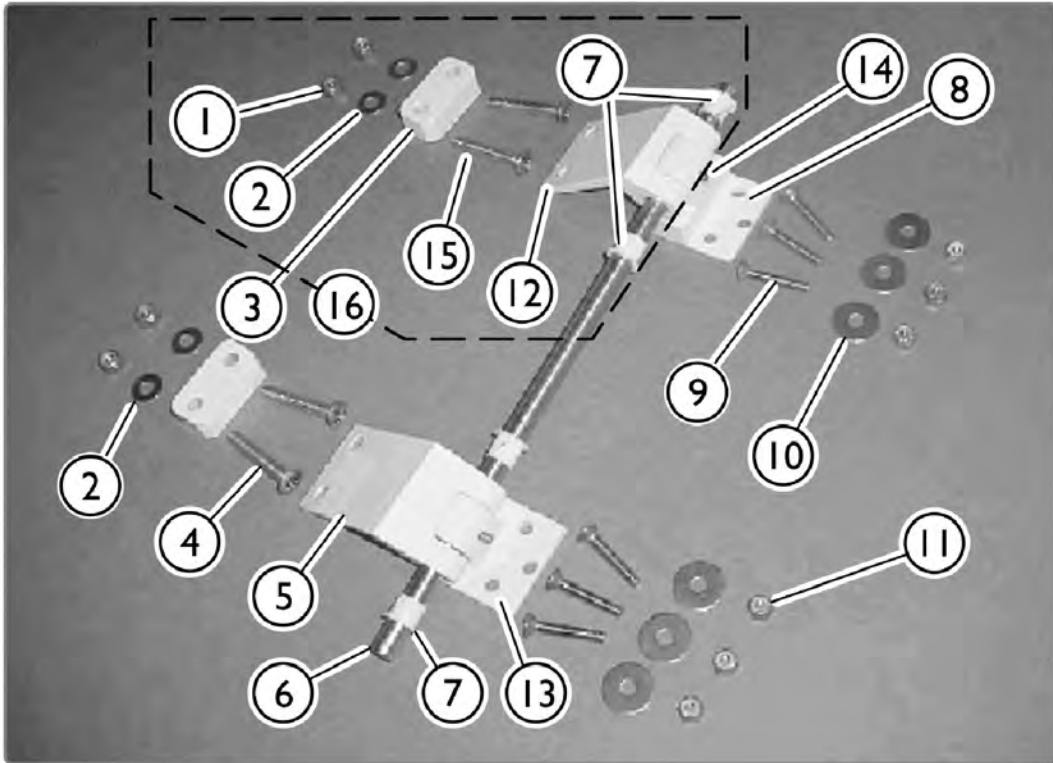

SPC_045A



Door Hinge Assembly

Item Number	Note	Part Number	Description	Quantity Per	
				Package	Assembly
1		PAR9921	Loc-Nut	1	4
2		PAR9919	Washer	1	4
3		IHPAR3610W	Spacer, Block, White (3/4")	1	2
3		IHPAR3611W	Spacer, Block, White (5/8")	1	2
3		IHPAR3612W-N LA	NLA - Spacer, Block, White (11/16")	1	2
4		PAR9920	Bolt, Door Hinge, Lower	1	2
5		IHPAR3622LB	Hinge, Lower Door, Bisque	1	1
6	A	IHPAR3615A	Pin, Door Hinge	1	1
7		IHPAR3609	Bushing, Hinge	1	4
8		IHPAR3623B	Bracket, Upper Door Hinge, Off White	1	1
9		1127641	Screw, Phillips, Flat Head (1/4-20 x 2")	1	6
10		PAR9918	Washer	1	6
11		PAR9916	Nut (1/4-20)	1	6
13		IHPAR3624B	Bracket, Lower Door Hinge, Off White	1	1
14		IHPAR3625	Screw, Set, Hinge Bracket	1	1
16	B	60001324	Kit, Upper Door Hinge, Off White	1	1

NOTE: A - IHPAR3615A (one piece hinge pin) replaces 2 of IHPAR3615 (single hinge pin).
B - If Tub was manufactured before 09/22/17, entire Kit item #16 part number 60001324 must be ordered. Includes items 1, 2, 7, 12 and 15. Item 12 and 15 are not sold separately. Item 15 Screws should be torqued to 45-60 in-lbs.

For item #12 and 15 order item #16 part number 60001324 as a replacement.

Door Probe Locking Assemblies

For Models 3600, 3600XL, 3700A, 3700B, 3700BMF, 3700D,
3700DMF, 3750, and 3800 unless noted otherwise.



SICC_071A

Door Probe Locking Assemblies

For Models 3600, 3600XL, 3700A, 3700B, 3700BMF, 3700D,
3700DMF, 3750, and 3800 unless noted otherwise.

Item Number	Note	Part Number	Description	Quantity Per	
				Package	Assembly
1		IHPAR9902	Screw, Hex Head (5/16-18 x 2")	1	1
1		PAR9919	Washer	1	1
1		IHPAR9903	Nut (5/16-18)	1	1
2	A,C	1145541	Bracket, Probe Swivel	1	1
2	B,C	IHPAR3743-NLA	NLA - Bracket, Probe Swivel includes #1	1	1
3		IHPAR3625	Screw, Set, Hinge Bracket	1	1
4	A,F	PAR3642-NLA	NLA - Bar, Probe Slide	1	1
4	B	IHPAR3742	Bar, Probe Slide	1	1
5		1127647	Nut, Hex (1/2-20)	1	2
6		IHPAR9852-NLA	NLA - Washer, Star Lock	1	2
7	D	IHPAR3641-NLA	NLA - Probe, Door	1	1
8	A,E	PAR3640	Mechanism, Complete Probe Locking	1	1
			NLA - Bar, Probe Slide	1	1
			Probe, Threaded	1	1
			Slide, Bracket Bar	1	1
			Screw, Set, Socket Head, Cup Point (5/16-18 x 2)	1	1
			Screw, Flat, Socket Head (1/4-20 x 1-1/2)	1	1
			Washer, Flat (5/16 x 3/4 x 3/64)	1	3
			Washer, Lock, Internal Tooth (1/2)	1	2
			Nut, Hex (1/4-20)	1	1
			Nut, Hex (1/2-20)	1	2
			Nut, Hex (5/16-18)	1	2
8	B,E	IHPAR3740-NLA	NLA - Mechanism, Complete Probe Locking	1	1

NOTE: A - For Models 3600, 3600XL, 3750, and 3800 ONLY.
B - For Models 3700A, 3700B, 3700BMF, 3700D, 3700DMF ONLY.
C - Also includes Item 1 (Screw, Nut, and Washer).
D - Also includes Items 5 (Hex Nut) and Item 6 (Lockwasher)
E - Also includes Items 1 - 7.
F - Part #PAR3642 is no longer available individually. Order item #8 PAR3640 that includes both part numbers PAR3642 and 1145541 together as a replacement.

Faceplate Components

Models - 3300, 3600, 3600XL, 3700, 3750, 3800, 4300, 5300

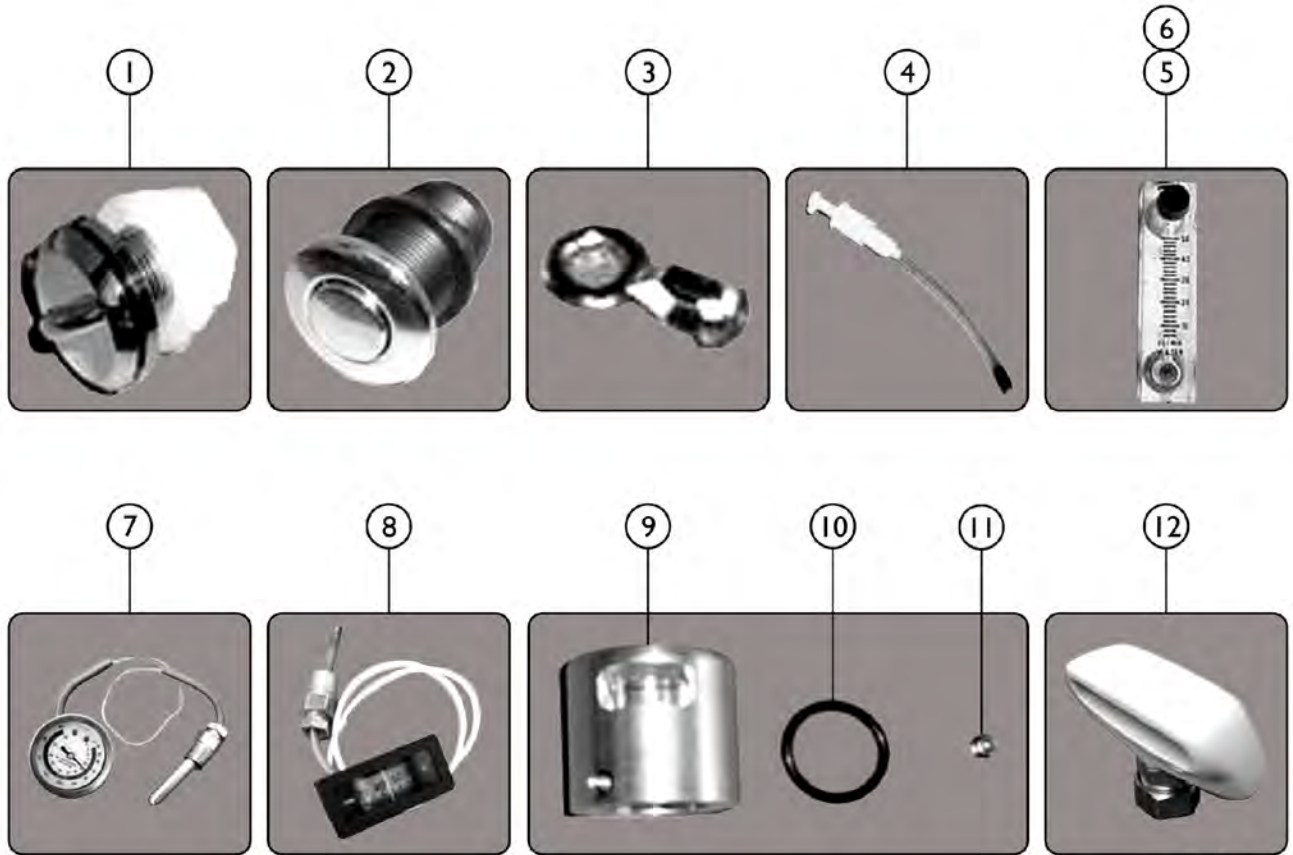

SICC_072A

Faceplate Components

Models - 3300, 3600, 3600XL, 3700, 3750, 3800, 4300, 5300

Item Number	Note	Part Number	Description	Quantity Per	
				Package	Assembly
1	B	PAR5590A-NLA	NLA - Air Vent Assembly, White	1	1
2		PAR5510C-NLA	NLA - On/Off Button	1	1
3		PAR9821	Chain Clip, Drain Plug	1	1
4		IHPAR1109-NLA	NLA - Soap Dispenser - DISCONTINUED	1	1
5		PAR1108	Metering Valve	1	1
6		IHPAR1106	Metering Valve Replacement Knob	1	1
7		PAR5710E	Gauge, Temperature	1	1
8		IHPAR5710E-LE NS-NLA	NLA - Replacement Lens (for PAR5710E) - DISCONTINUED	1	1
9		IHPAR6090-C-N LA	NLA - Spout, Aluminum Tub (Old style)	1	1
10	A	IHPAR6091C-NL A	NLA - O-Ring	1	1
11	A	IHPAR6092C-NL A	NLA - Screw, Set	1	1
12		IHPAR6089-A-N LA	NLA - Spout, Tub	1	1
12		IHPAR6089	Tub Spout (New Style)	1	1
NOTE: A - For IHPAR6090-C, Aluminum tub spout B - White Air Vent Assembly replaced Chrome. Functionality is the same.					

Faceplates

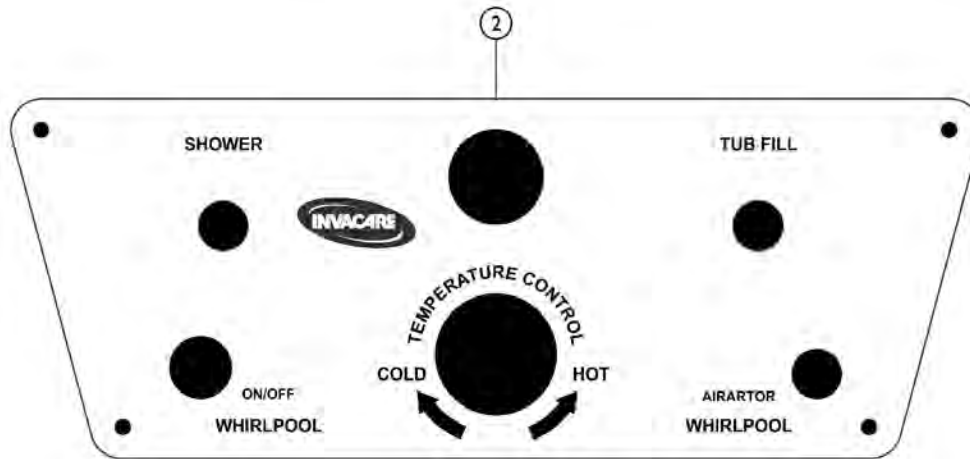
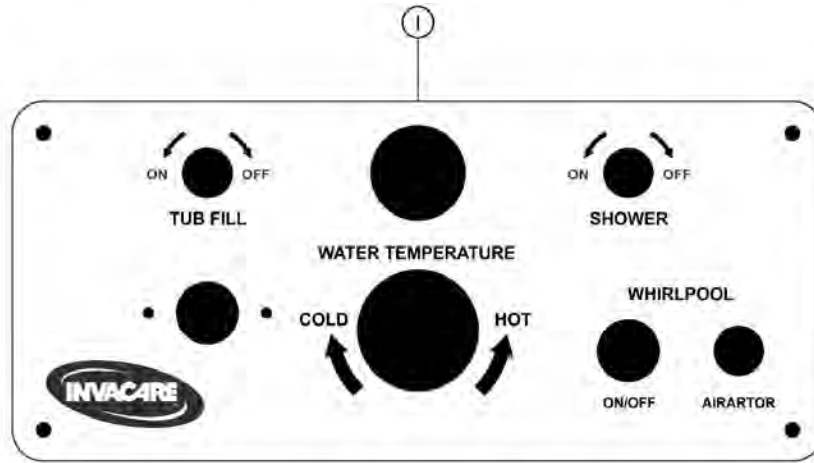

SICC_081A

Item Number	Note	Part Number	Description	Quantity Per	
				Package	Assembly
1	A	PAR9203B	Faceplate, Tub, Bisque (19")	1	1
2	B	IHPAR9203XB-N LA	NLA - Faceplate, Tub, Bisque	1	1

NOTE: A - Used with 3600, 3600XL, 3300, 4300, and 5300 Tub Models.
B - Used with 3700, 3750, and 3800 Tub Models.

Safety Harness and Grab Bar

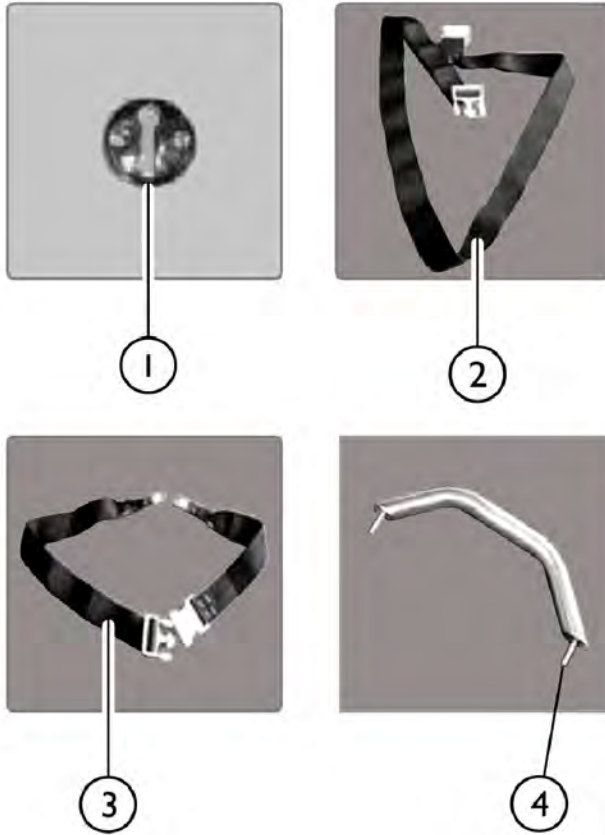

SICC_012C

Item Number	Note	Part Number	Description	Quantity Per	
				Package	Assembly
1		PAR9269B	Tub Catch, Chrome	1	1
2		PAR9268ABC	Chest Safety Harness	1	1
3		PAR9260	Seat Safety Harness	1	1
4		IHPAR9261	Grab Bar (10")	1	1

Inner Tub Shell Components

Models 3300, 3600, 3600XL, 3700, 3800, 4300, 5300

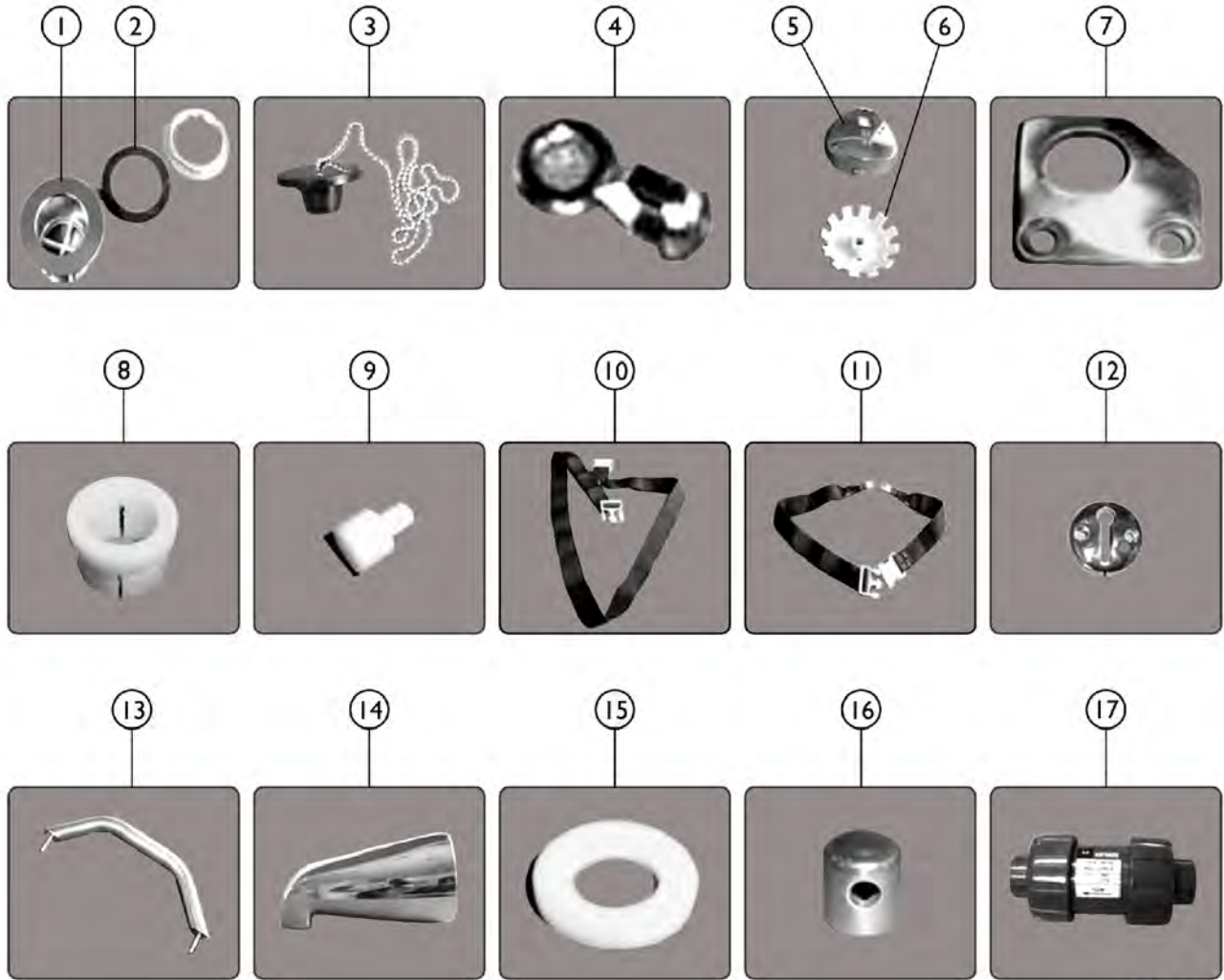

SICC_073A

Inner Tub Shell Components

Models 3300, 3600, 3600XL, 3700, 3800, 4300, 5300

Item Number	Note	Part Number	Description	Quantity Per	
				Package	Assembly
1		60106483-NLA	NLA - Drain Assembly (2")	1	1
2		PAR7188	Gasket	1	1
3		PAR9817A	Plug, Drain with Chain	1	1
4		PAR9821	Chain Clip, Drain Plug	1	1
6		IHPAR5139D-NL A	NLA - Handle Adapter, Gerberit	1	1
5		IHPAR5138D-NL A	NLA - Drain Handle, Gerberit	1	1
7	A	PAR3614	Plate, Door Probe	1	1
8	B	PAR3602-NLA	NLA - Bushing, Door Probe	1	1
9		PAR3619	Stop, Door	1	1
10		PAR9268ABC	Chest Safety Harness	1	1
11		PAR9260	Seat Safety Harness	1	1
12		PAR9269B	Tub Catch, Chrome	1	1
13	C	IHPAR9261	Grab Bar (10")	1	1
14	D	IHPAR9005A	Spout, Tub	1	1
15		IHPAR3617A-NL A	NLA - Washer, Disinfectant Burp Fitting	1	1
16		IHPAR3617-NLA	NLA - Burp Fitting, Disinfectant	1	1
17		IHPAR5670-BC D-NLA	NLA - Check Valve, 1/2" (4 and 6 jet tubs only)	1	1

NOTE: A - Used on Tubs built 1995 and after.
 B - Used on Tubs built prior to 1995.
 C - Used on Models 3750, 3752G, 3800, and 3802G only.
 D - Used on Model 3700 Series Tub only.

Whirlpool Inlet Assembly

WHEN REPLACING THE INLET SUCTION GUARD HEAD
THE TORQUE SPECIFICATION IS 9 - 11 FT./LBS.



1



2



3



4



5



6

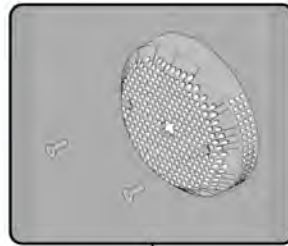

7

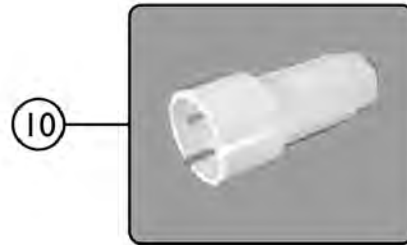
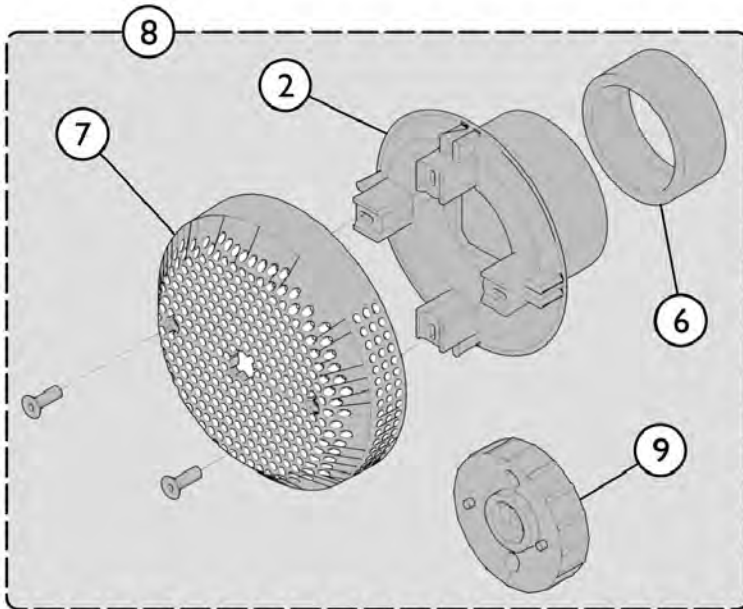

10

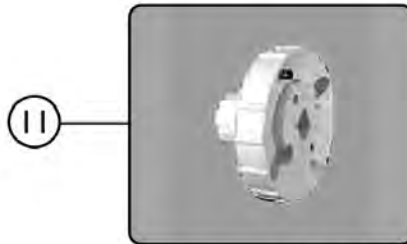

11

SICC_074A

Whirlpool Inlet Assembly

WHEN REPLACING THE INLET SUCTION GUARD HEAD
THE TORQUE SPECIFICATION IS 9 - 11 FT./LBS.

Item Number	Note	Part Number	Description	Quantity Per	
				Package	Assembly
1	A	PAR7185A	Inlet Suction Assembly	1	1
2	C	PAR7185G-A	Inlet Suction Guard Head	1	1
3		PAR7185112-NL A	NLA - Elbow Housing (2 x 1-1/2")	1	1
4		1095446	Valve, Stem	1	1
5		PAR7188	Gasket	1	1
6		PAR9816	Insert, Ring (1-1/2")	1	1
7		PAR7185B-W	Inlet Suction Cover - White	1	1
8	D	1170078-NLA	Kit, Whirlpool Inlet Assembly	1	1
2			Inlet Suction Guard Head	1	1
6			Insert, Ring (1-1/2")	1	1
7			Inlet Suction Cover - White	1	1
9			Wrench, Flange Spanner (For Jet Flange and Inlet Suction Guard Heads)	1	1
			Instruction Sheet	1	1
10		IHPAR7186	Wrench, Jet Spanner	1	1
11		IHPAR7187	Wrench, Flange Spanner (For Jet Flange and Inlet Suction Guard Heads)	1	1
<p>NOTE: A - Includes Items 2, 3, 5, and 6. C - Order items 6, 7, and item 11 also. D - Not available to order.</p>					

Jet Assembly

WHEN REPLACING THE JET FLANGE,
THE TORQUE SPECIFICATION IS 9 - 11 FT./LBS.

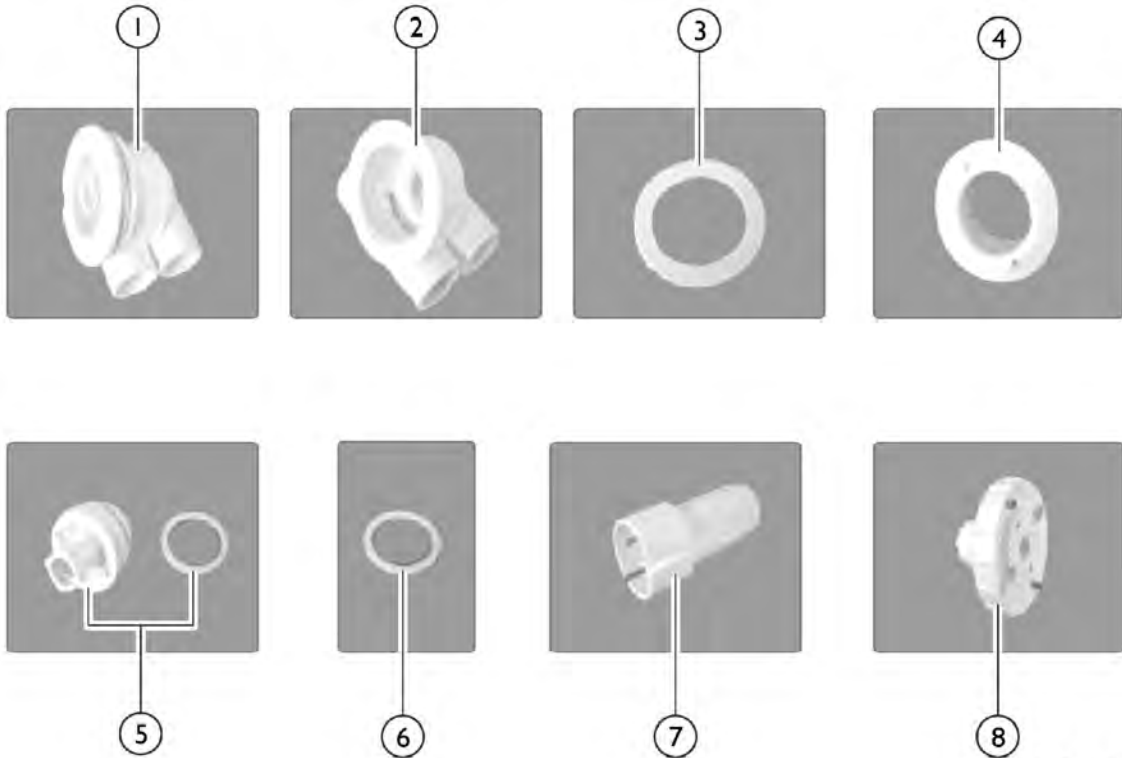

SICC_009A

Item Number	Note	Part Number	Description	Quantity Per	
				Package	Assembly
1		1094363	Jet Assembly, White	1	1
2		PAR7182E	Jet Housing	1	1
3		PAR7188	Gasket	1	1
4		IHPAR7185F-W S	Nut, White Flange	1	1
5		IHPAR7185EWP P	Push and Pull Jet and Gasket	1	1
6		IHPAR7189	Gasket, Replacement Jet	1	1
7		IHPAR7186	Wrench, Jet Spanner	1	1
8		IHPAR7187	Wrench, Flange Spanner (For Jet Flange and Inlet Suction Guard Heads)	1	1

Overflow Assembly

WHEN REPLACING THE JET FLANGE,
THE TORQUE SPECIFICATION IS 9 - 11 FT./LBS.

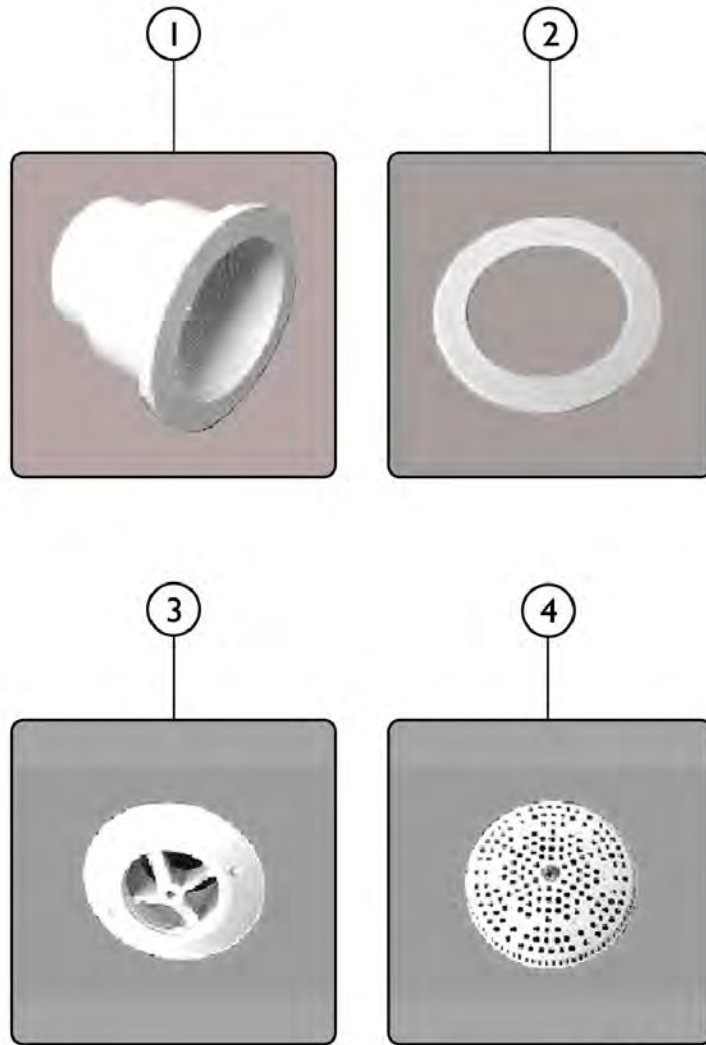

SICC_075A

Item Number	Note	Part Number	Description	Quantity Per	
				Package	Assembly
1		1095605-NLA	NLA - Overflow Housing	1	1
2		PAR7188	Gasket	1	1
3		PAR7185G-B	Overflow Guard Head	1	1
4		PAR7185C-W	Cover and Screws, White Overflow	1	1

Mixing Valves

RADA 17

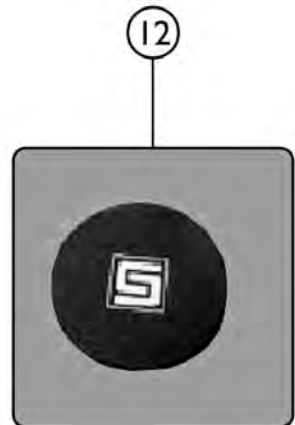
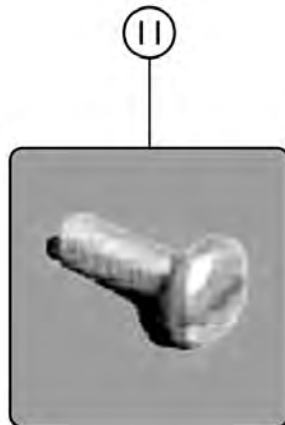
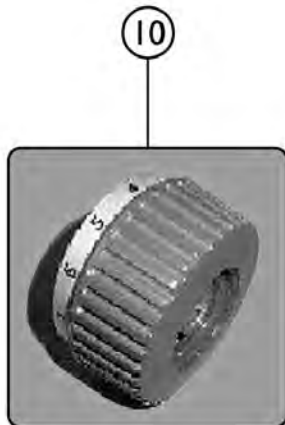
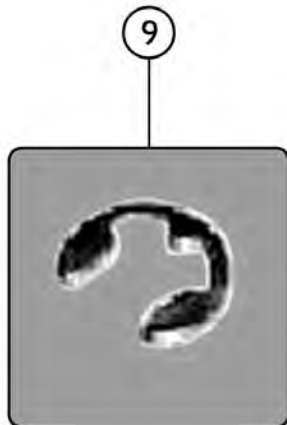
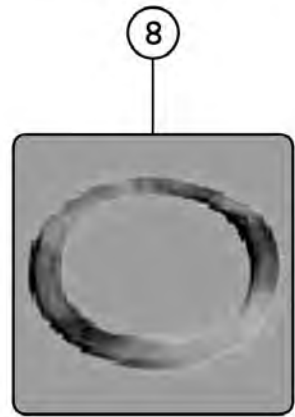
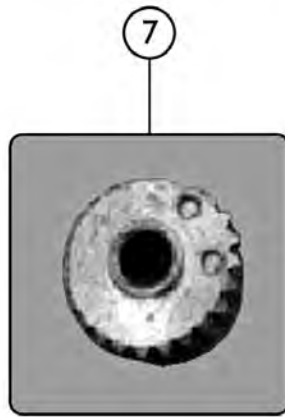
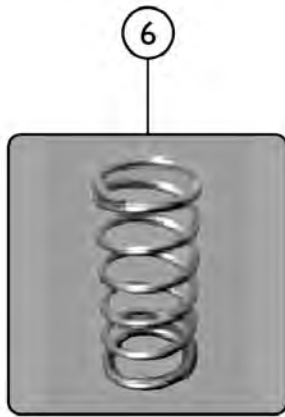
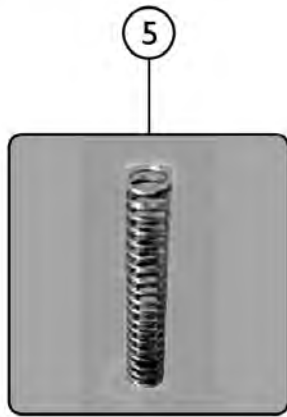
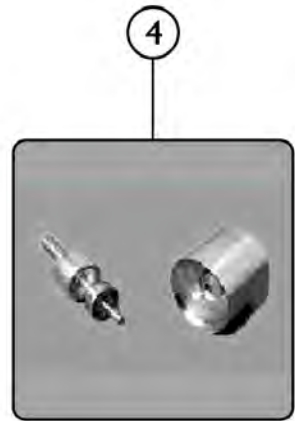
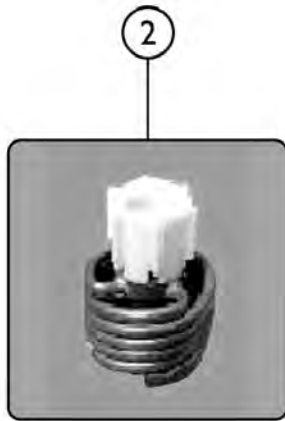

SICC_076A

Mixing Valves

RADA 17

Item Number	Note	Part Number	Description	Quantity Per	
				Package	Assembly
1		IHPAR6692-CG-NLA	NLA - Cartridge Assembly, Complete RADA 17	1	1
2		IHPAR9124-CG-NLA	NLA - Thermoscopic Assembly	1	1
3		IHPAR6695-CG-NLA	NLA - Valve Spindle	1	1
4		PAR6694-CG-NLA	NLA - Shuttle Sleeve and Actuator Assembly	1	1
5		IHPAR9129CG-NLA	NLA - Spring, Long	1	1
6		IHPAR9130CG-NLA	NLA - Spring, Short	1	1
7		IHPAR9120-CG-NLA	NLA - Hub, Brass	1	1
8		IHPAR9123-CG-NLA	NLA - Washer, Pressure	1	1
9		IHPAR9121-CG-NLA	NLA - Cir-Clip	1	1
10		IHPAR6693-CG-NLA	NLA - Control Knob, Blue	1	1
11		IHPAR9122-CG-NLA	NLA - Screw, Brass, Control Knob	1	1
12		IHPAR9127-CG-NLA	NLA - Concealing Cap, Control Knob	1	1
	A	IHPAR6691-CG-NLA	NLA - Service Pack, Mixing Valve, RADA 17	1	1

NOTE: A - Not Shown. Item includes all O-Rings, Lubes, and Screens).

Mixing Valves

RADA20

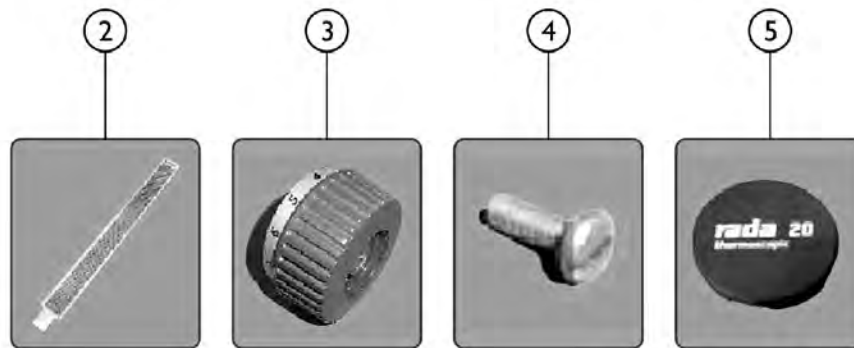

SICC_078A

Item Number	Note	Part Number	Description	Quantity Per	
				Package	Assembly
1		IHPAR6699-CG-NLA	NLA - Kit, RADA 20 Mixing Valve	1	1
2		IHPAR6696-CG-NLA	NLA - Strainer Screen	1	1
3		IHPAR6693-CG	NLA - Control Knob, Blue	1	1
4		IHPAR9122-CG-NLA	NLA - Screw, Brass, Control Knob	1	1
5		IHPAR6698J-NL A	NLA - Cap, Concealing	1	1
	A	IHPAR6698G-NL A	NLA - Service Pack, Mixing Valve, RADA 20	1	1

NOTE: A - Not Shown. Item includes all O-Rings, Lubes, and Screens).

Mixing Valves

RADA 222



Mixing Valves

RADA 222

Item Number	Note	Part Number	Description	Quantity Per	
				Package	Assembly
1		PAR6670CG	NLA - Valve, Complete RADA Mixing	1	1
2		PAR6676CG	Cartridge, Replacement	1	1
3		PAR6674CG	Hub, Yellow	1	1
4		PAR6673CG-C	Handle Assembly, Chrome	1	1
4		PAR6673CG-W	NLA - Handle Assembly, White	1	1
5		PAR6672CG	NLA - Set Screw Handle	1	1
6		IHPAR6675	Nut, Head	1	1
7		PAR6675CG	Clip, Removal, Yellow	1	1
8		PAR6677CG	Valve, Inlet Check	1	1
9		PAR6669CG-NL A	NLA - Elbow, 90 Degree, Compression Fitting	1	1
10		PAR6679CG-NL A	NLA - Fitting, Straight Compression	1	1
	A	IHPAR6681-CG	Service Pack, Mixing Valve, RADA 222	1	1

NOTE: A - Not Shown. Item includes all O-Rings, Lube, and Screens.

Outer Tub Shell and Components

Models 3300, 3600, 3600XL, 3700, 3800, 4300, 5300

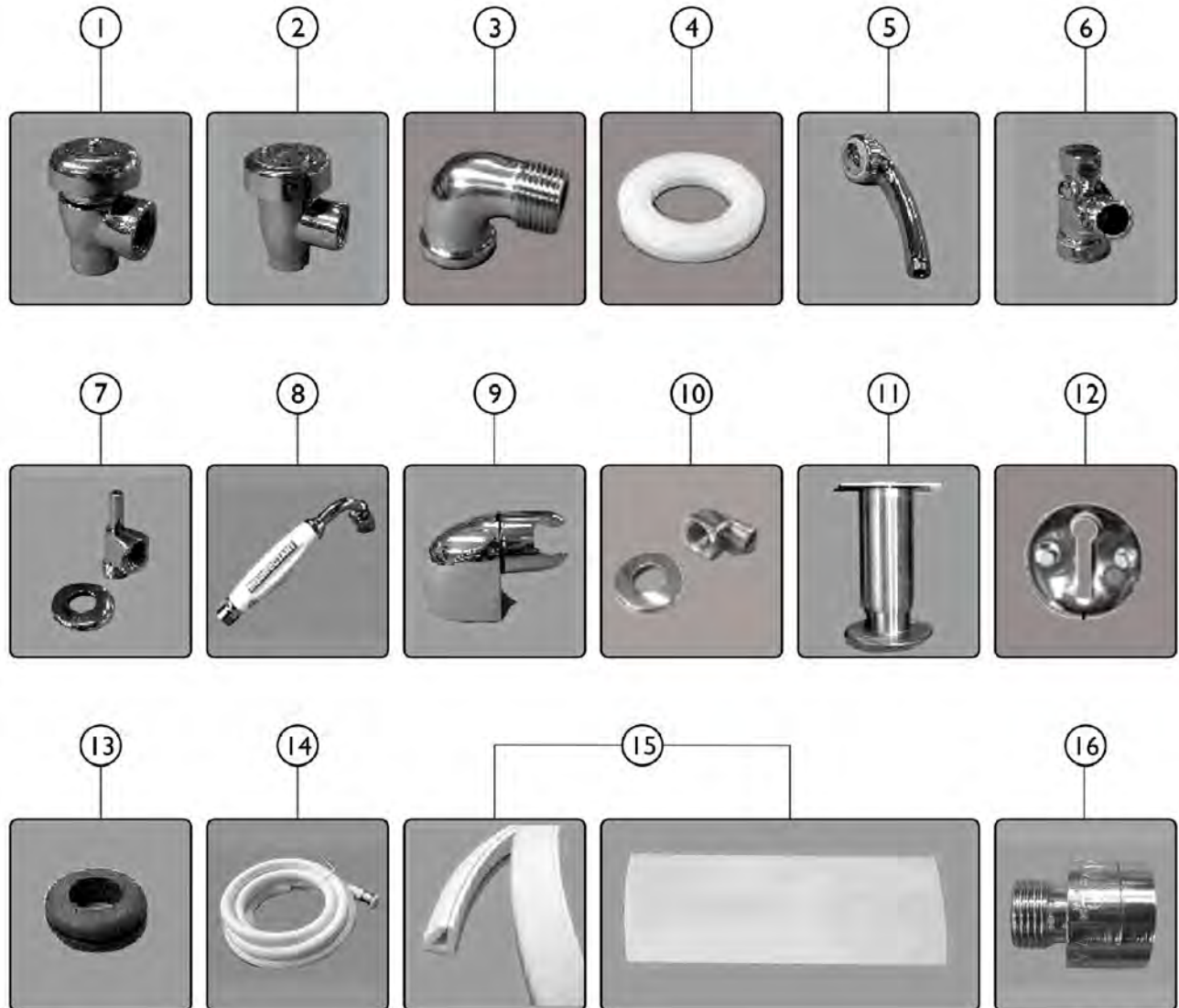

SICC_080A

Outer Tub Shell and Components

Models 3300, 3600, 3600XL, 3700, 3800, 4300, 5300

Item Number	Note	Part Number	Description	Quantity Per	
				Package	Assembly
1		PAR7380AG	Back Flow Preventer - Conbraco (1/2") (One Screw in Cap)	1	1
1a	D	IHPAR7383C	Bonnet	1	1
		IHPAR7384C	Kit, Repair	1	1
2		IHPAR7380-AG-W-NLA	NLA - Back-Flow Preventer, "WATTS" 1/2" (Two screws in cap)	1	1
2		IHPAR7382CW-NLA	NLA - Bonnet	1	1
		IHPAR7384CW-NLA	NLA - Kit, Repair	1	1
3		PAR1136	Elbow, 90 Degrees - Chrome	1	1
4		PAR6160D	Washer, Nylon, Backflow Preventer and Chrome Elbow	1	1
5		PAR5080BC	Wand, Shower	1	1
6		PAR5100AC-NLA	NLA - Swivel Connector, Shower Wand	1	1
7		PAR9167B	Holder, Shower Wand	1	1
8		PAR5087B-NLA	NLA - Wand, Disinfectant	1	1
9		PAR9170B	NLA - Holder, Disinfectant Wand	1	1
10	B	PAR9167A	Connector, Chrome Elbow, Hose	1	1
11		IHPAR3645	Leg (6")	1	1
11		IHPAR3646	Leg (10")	1	1
12		PAR9269B	Tub Catch, Chrome	1	1
13		PAR5291-NLA	NLA - Grommet, Rubber	1	1
14		PAR5118G	Hose, Shower and Disinfectant Wand	1	1
15	A	IHPAR5940BC1	NLA - Molding, Trim, Almond	1	1
15	A	IHPAR5940BC	Molding, Trim - White	1	1
15	E	IHPAR1904W	Molding, Trim - White	1	1
16	C	1146438	Preventer, External, Back Flow	1	1

NOTE: A - Used on Base of all freestanding Tubs and end panels on recessed Tubs.
B - For Disinfectant Wand.
C - For Tubs sold in LA County, Wisconsin, and Oregon only.
D - Not Shown in photos.
E - Used on 3600, 3600XL, 2300, 3300, 4300, 5300.

Pump

Ultra Flow (Effective February 1991)

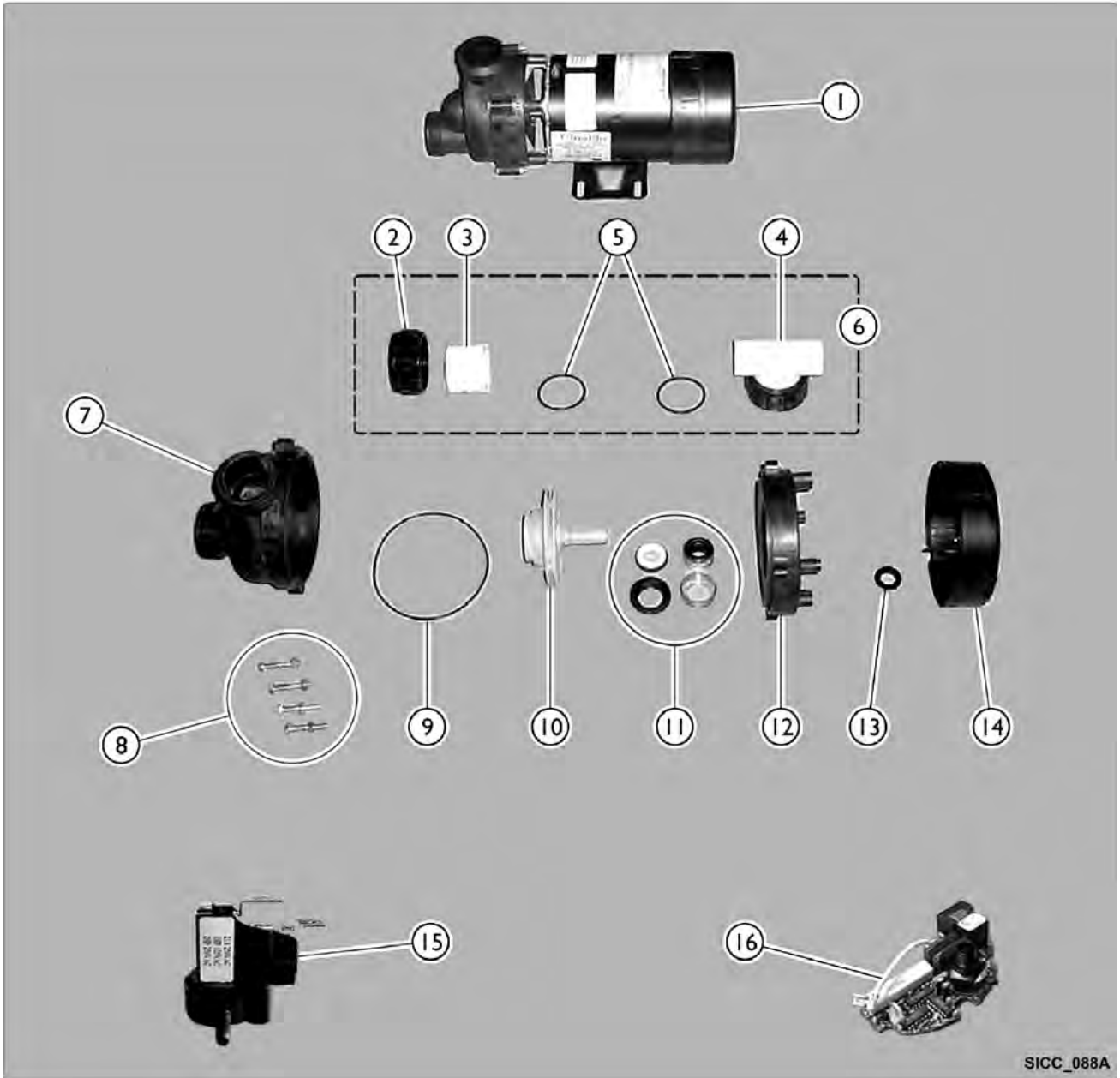

SICC_088A

Pump

Item Number	Note	Part Number	Description	Quantity Per	
				Package	Assembly
1		PAR5295A-NLA	NLA - Pump, 3/4HP / 110V, with Air Switch	1	1
2		PAR5295K-NLA	NLA - Nut, Union	1	1
3		PAR5295J-NLA	NLA - FE Piece	1	1
4		PAR5295I	Union "T"	1	1
5		PAR5295L-NLA	NLA - O-Ring	1	1
6	A	PAR5295C-NLA	NLA - Union and "T" Set Assembly	1	1
7		PAR5295H-NLA	NLA - Volute Front	1	1
8		PAR5295M-NLA	NLA - Bolt and Nut	1	1
9		PAR5295E	O-Ring	1	1
10		PAR5295G	Impellor	1	1
11		PAR5295B	Seal Assembly	1	1
12		PAR5295D-NLA	NLA - Volute Back	1	1
13		PAR5295F-NLA	NLA - Slinger	1	1
14		IHPAR5295Z-NL A	NLA - Cover, Motor Dust	1	1
15		IHPAR5295N-NL A	NLA - Switch, Air	1	1
16		IHPAR5295O-NL A	NLA - Switch, Air w/ Load Sensor Board	1	1

NOTE: A - Also includes Items 2 (Union Nut), 3 (FE Piece), 4 (T Union), and 5 (O-Ring)



Plastic Tubing and Fittings

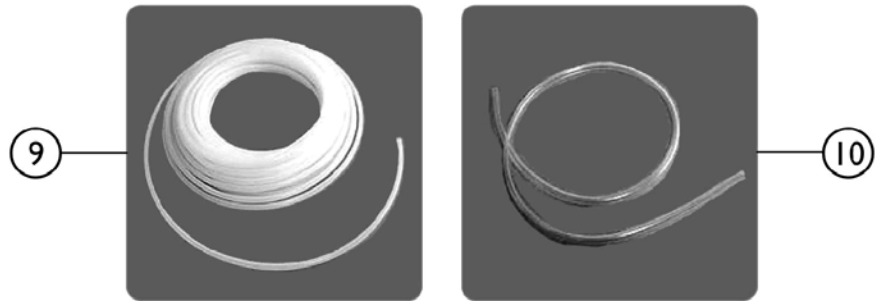
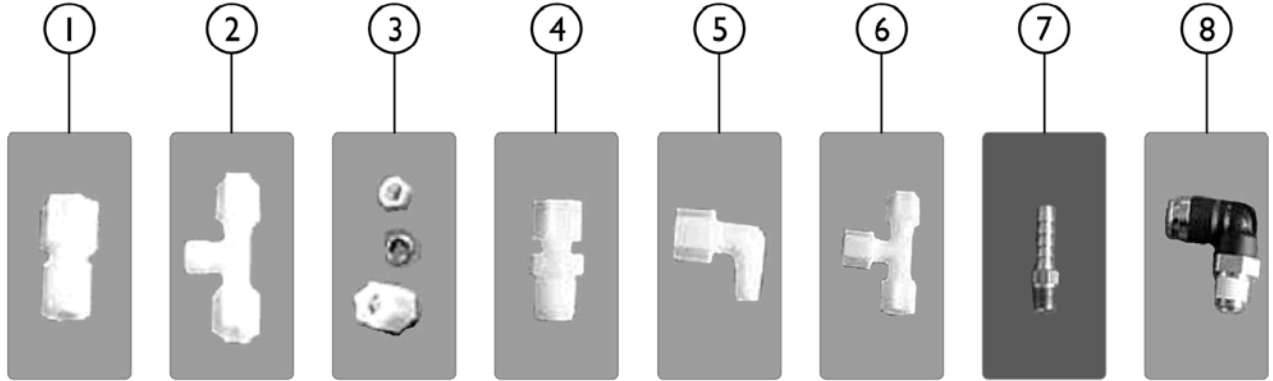

SICC_085A

Plastic Tubing and Fittings

Item Number	Note	Part Number	Description	Quantity Per	
				Package	Assembly
1		IHPAR1156	NLA - Connector, Female (3/8" tube x 1/4" MP)	1	1
1		IHPAR6116C	NLA - Connector, Female (1/4" Tube x 1/4" MP)	1	1
2		IHPAR9177A	Male Branch "T" (1/4" Tube x 1/4" Tube x 1/8" MP)	1	1
2		IHPAR6115C	NLA - Male Branch "T" (1/4" Tube x 1/4" Tube x 1/4" MP)	1	1
3		IHPAR1153	NLA - Nut, Compression (1/4")	1	1
3		IHPAR1154-NLA	NLA - Nut, Compression (3/8")	1	1
4		IHPAR5675C	NLA - Connector, Male (1/4" Tube x 1/8" MP)	1	1
4		IHPAR1164	NLA - Connector, Male (1/4" Tube x 1/4" MP)	1	1
4		PAR1160	Connector, Male (3/8" Tube x 1/4" MP)	1	1
4		PAR1161	Connector, Male (3/8" Tube x 3/8" MP)	1	1
4		PAR1162	Connector, Male (3/8" Tube x 1/2" MP)	1	1
4		PAR1159	Connector, 90 Degree, Male (3/8" Tube x 1/4" MP)	1	1
5		IHPAR5690BC	NLA - Elbow, Male, 90 Degrees (1/4" Tube x 1/8" MP)	1	1
5		PAR5680BC	Elbow, Male, 90 Degrees - 1/4" Tube x 1/4" MP	1	1
5		IHPAR1158	NLA - Elbow, Male, 90 Degrees (1/4" Tube x 3/8" MP)	1	1
5		IHPAR1157	NLA - Elbow, Male, 90 Degrees (3/8" Tube x 3/8" MP)	1	1
6		IHPAR6118C	NLA - Union "T" (1/4")	1	1
6		PAR1163-NLA	NLA - Union "T" (3/8")	1	1
7		PAR1130-NLA	NLA - Fitting, Brass Barb (1/4" Barb x 1/8" MP)	1	1
8		IHPAR1169	Elbow, 90 Degree Push-Loc (3/8" tube x 1/4" MP)	1	1
9	A	PAR5561BCD	Tubing, Plastic, Water Supply (3/8" OD x 1/4" ID)	1	1
9	A	IHPAR5570BC	NLA - Tubing, Plastic (1/4" OD x 1/8" ID)	1	1
10	A	PAR5580ABC-NLA	NLA - Tubing, Clear Vinyl (1/4" OD x 1/8" ID)	1	1
10	A	IHPAR5563	NLA - Tubing, Clear Vinyl (3/8" OD x 1/4" ID)	1	1

NOTE: A - Sold by the foot.

PVC Fittings and Pipe

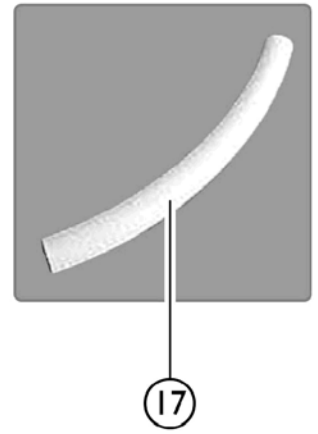
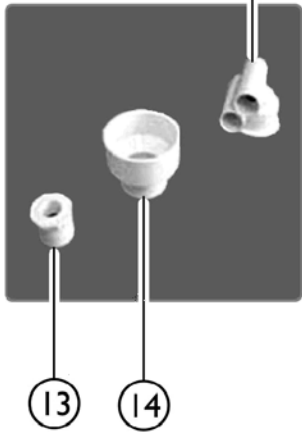
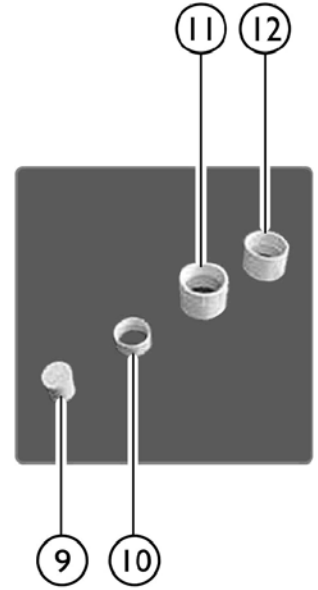
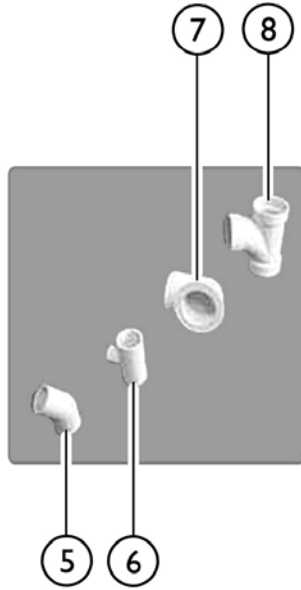
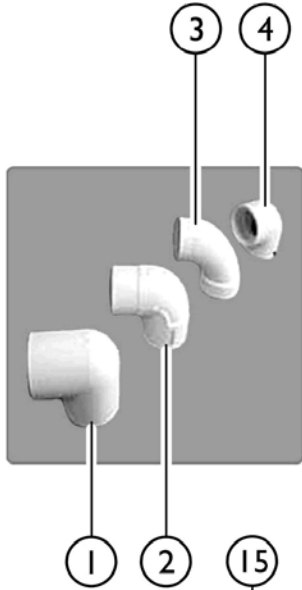

SICC_086A

PVC Fittings and Pipe

Item Number	Note	Part Number	Description	Quantity Per	
				Package	Assembly
1		PAR5815-NLA	NLA - Elbow, 90 Degree (1")	1	1
1		PAR5760C	Elbow, 90 Degree (1-1/2")	1	1
1		IHPAR5753C	NLA - Elbow, 90 Degrees (2")	1	1
2		PAR5780C-NLA	NLA - Elbow, Street, 90 Degree (1")	1	1
2		IHPAR5840-BC-NLA	NLA - Elbow, 90 Degrees Street 1-1/2"	1	1
2		IHPAR5750C	NLA - Elbow, 90 Degrees Street (2")	1	1
3		PAR8082WT	Elbow, 90 Degree, Wide Turn (2")	1	1
4		PAR5816C	90 Degree Threaded Elbow (2")	1	1
5		IHPAR5879C	Elbow, 45 Degrees (1")	1	1
6		PAR5810C-NLA	NLA - Reducing "T" (1 x 1 x 1/2")	1	1
6		PAR5820C-NLA	NLA - Fitting, Tee (1 x 1 x 1")	1	1
7		PAR7185112-NLA	NLA - Elbow Housing (2 x 1-1/2")	1	1
7		IHPAR7185-2	Housing, Elbow, Threaded 90 Degrees (2")	1	1
8		PAR5780BC	Reducing "T", Sanitary (2 x 2 x 1-1/2")	1	1
8		IHPAR8085-NLA	NLA - Sanitary "T" (2")	1	1
9		PAR5880C-NLA	NLA - Plug (1")	1	1
10		PAR9816	Insert, Ring (1-1/2")	1	1
11		IHPAR2834-NLA	NLA - Coupling, Threaded (1-1/2")	1	1
11		PAR8083	Threaded Adapter (2") (Connects to Drain)	1	1
12		IHPAR5761C-NLA	NLA - Coupling (1-1/2")	1	1
12		IHPAR5762C	NLA - Coupling (2")	1	1
13		IHPAR8086-NLA	NLA - Reducer, Bushing (2 x 1-1/2")	1	1
14		IHPAR5743C	NLA - Reducer (3 x 2")	1	1
15		PAR7182E	Jet Housing	1	1
16	A	PAR8080-NLA	NLA - PVC Pipe (1-1/2") (Sold by the foot)	1	1
16	A	PAR8081-NLA	NLA - PVC Pipe (2") (Sold by the foot)	1	1
17	A	PAR5630B	Flex Pipe (1") (Sold by the foot)	1	1
17	A	PAR5640B	Flex Pipe (1-1/2") (Sold by the foot)	1	1

NOTE: A - Sold by the foot.

Tub and Shower Valves

For Lynwood and Gerber

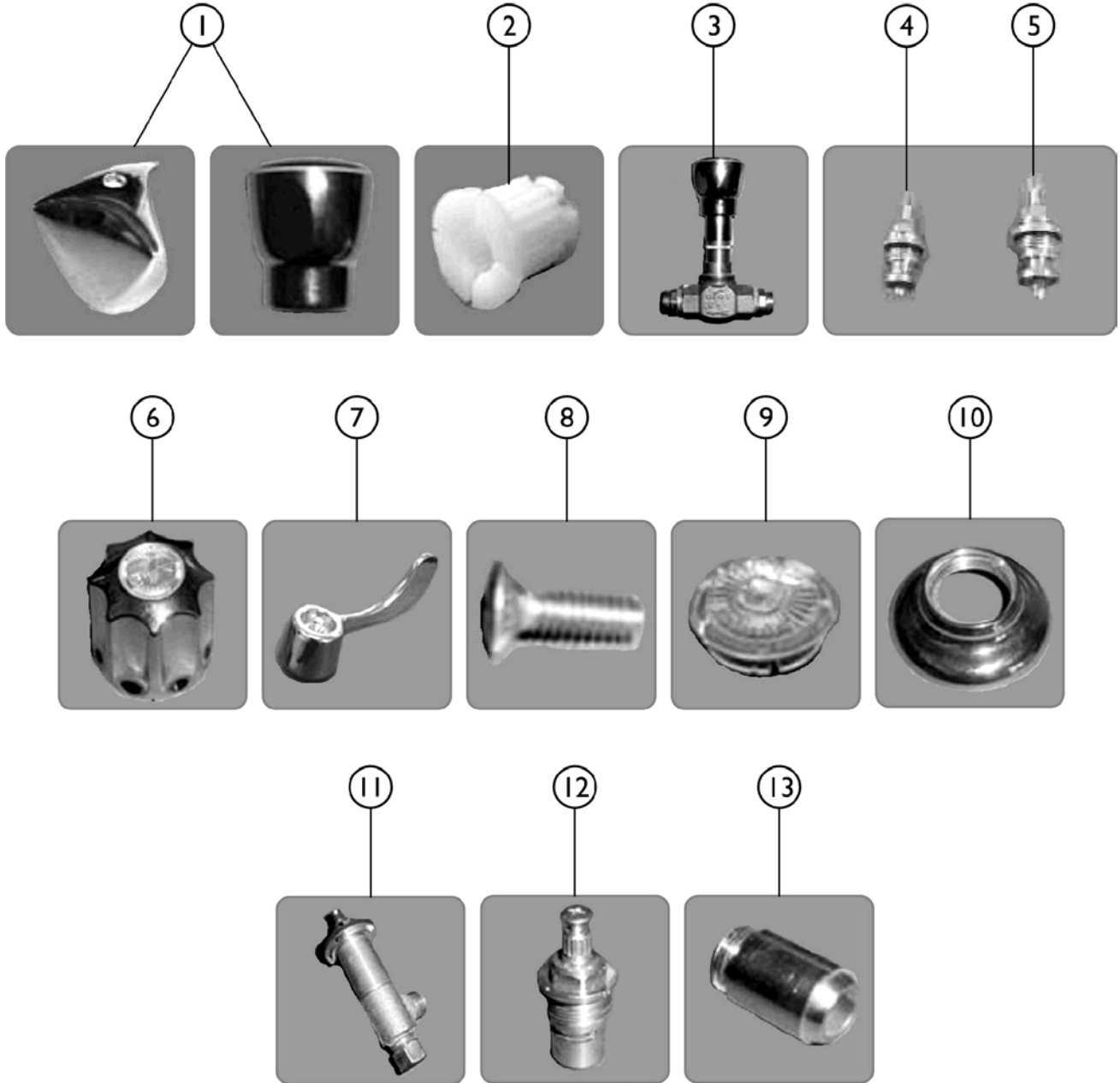

SICC_083A

Tub and Shower Valves For Lynwood and Gerber

Item Number	Note	Part Number	Description	Quantity Per	
				Package	Assembly
1	A	PAR6652A-NLA	NLA - Handle, Lynwood Plastic (Metal no longer available)	1	1
2	A	PAR6678CG-NL A	NLA - Handle Insert, Dornbracht	1	1
3	A	IHPAR6652-NLA	NLA - Valve, Shower (1/2")	1	1
3	A	PAR6653	Valve, Fill, Tub (3/4")	1	1
4	A	PAR6652B-NLA	NLA - Stem and Cartridge, Shower (1/2")	1	2
5	A	PAR6653B	Stem and Cartridge, Tub Fill (3/4")	1	1
6	B	IHPAR6102C-NL A	NLA - Handle, Gerber	1	1
7	B	IHPAR6093-NLA	NLA - Handle, Gerber Wrist (3700 model series only)	1	1
8	B	IHPAR6112C-NL A	NLA - Screw, Handle	1	1
9	B	IHPAR6100C-NL A	NLA - Handle Cap	1	1
10	B	IHPAR6103C-NL A	NLA - Escutcheon, Gerber	1	1
11	B	IHPAR6098C-NL A	NLA - Valve, 1/2" Tub and Shower	1	1
12	B	PAR6097C-NLA	NLA - Cartridge, Valve Replacement (New Style Only)	1	1
13	B	IHPAR6099C-NL A	NLA - Valve Seat (Old style only)	1	1

NOTE: A - Lynwood (effective August, 1995)
B - Gerber

Tub and Shower Valves

For Dornbracht "Aida", Gummerts, and Symmons

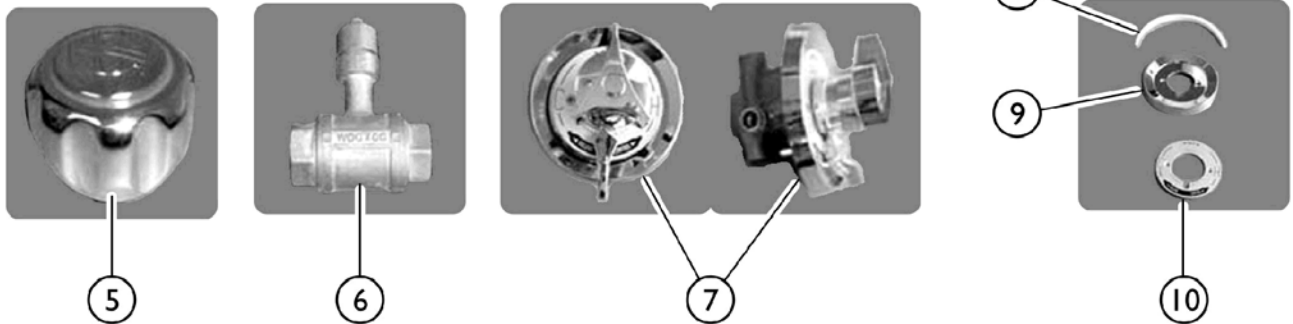
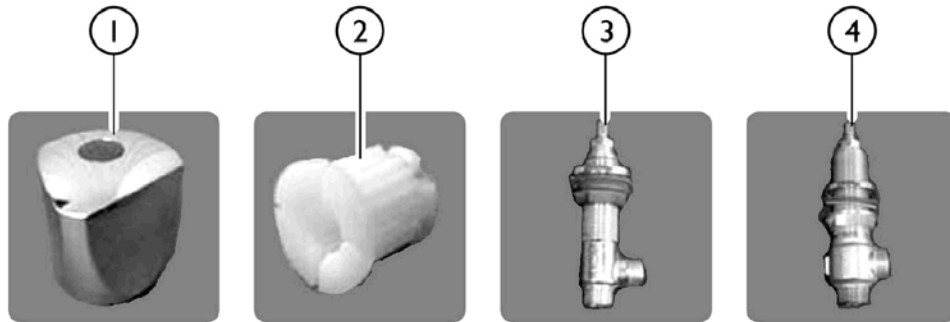

SICC_082A

Tub and Shower Valves

For Dornbracht "Aida", Gummings, and Symmons

Item Number	Note	Part Number	Description	Quantity Per	
				Package	Assembly
1	A	IHPAR9301-NLA	Handle, Dornbracht - (For "Adia" model only)	1	1
2	A	PAR6678CG-NL A	NLA - Handle Insert, Dornbracht	1	1
3	A	IHPAR9314-NLA	Valve, 1/2" Shower	1	1
4	A	IHPAR9315-NLA	Valve, 3/4" Tub Fill	1	1
5	B	IHPAR6887BC-NLA	Handle, Gummings	1	1
6	B	IHPAR6885-BC-NLA	NLA - Valve, 3/4" Tub and Shower	1	1
7	C	IHPAR9255-NLA	Valve Kit, 3/4" Tub and Shower	1	1
8	C	IHPAR9255A-NL A	NLA - Gasket, Escutcheon - Mfg# T-27	1	1
9	C	IHPAR9255B-NL A	NLA - Escutcheon - Mfg# T-27B	1	1
10	C	IHPAR9255C-NL A	NLA - Plate, Dial - Mfg# T-29B	1	1

NOTE: A - Dornbracht "Aida"
B - Gummings
C - Symmons - Used on Model 3700, 3700B, and 3700BMF ONLY



Accessories - Optional

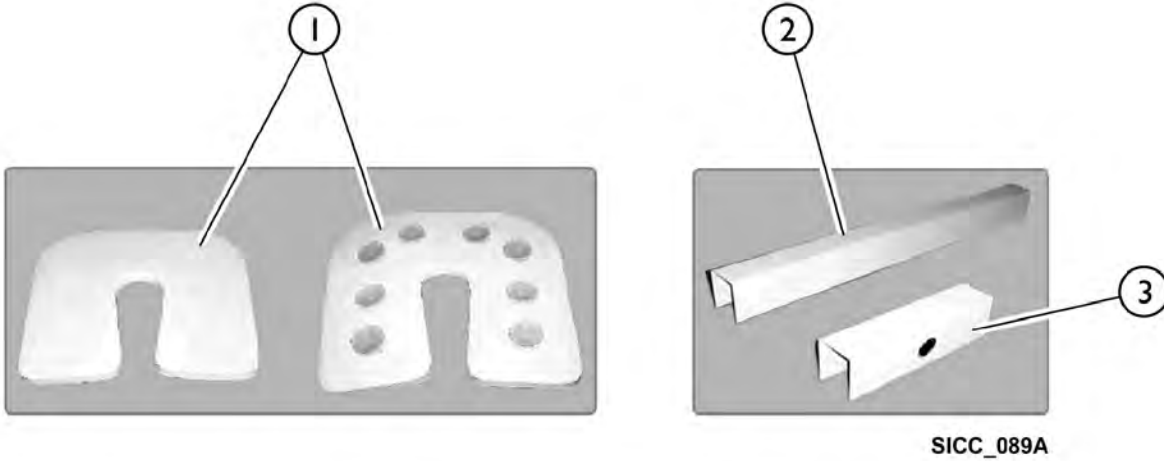

Item Number	Note	Part Number	Description	Quantity Per	
				Package	Assembly
1		IHPAR9800-NLA	NLA - Cushion, Tub Seat, White ONLY (16" x 18" x 3/4")	1	1
2		IHPAR9670	Guard, Tub Rim (48")	1	1
3		IHPAR9669	Guard, Tub Rim - Long	1	1
		IHPAR9243W-NLA	NLA - Gel - Coat Kit, White	1	1
		IHPAR9243B	Gel - Coat Kit, Bisque	1	1
		IHPAR9243A	NLA - Gel - Coat Kit, Almond	1	1

